

PLB 9
PG 70

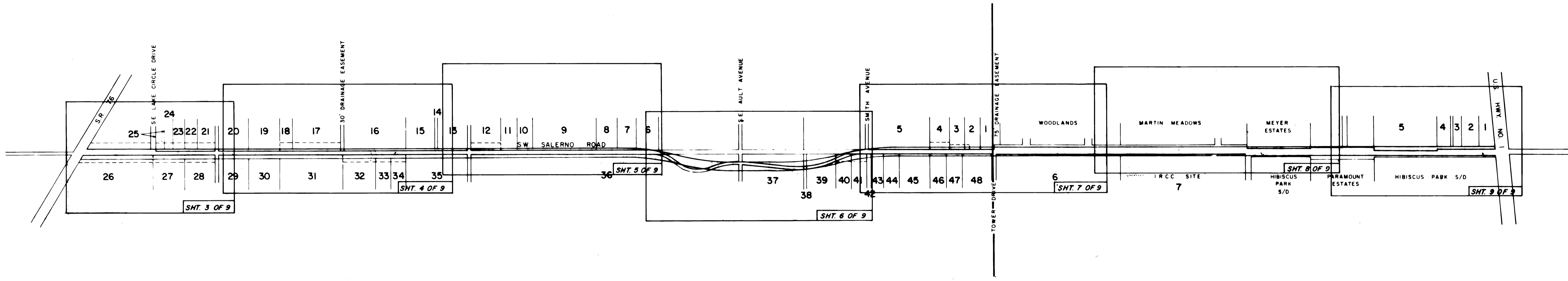
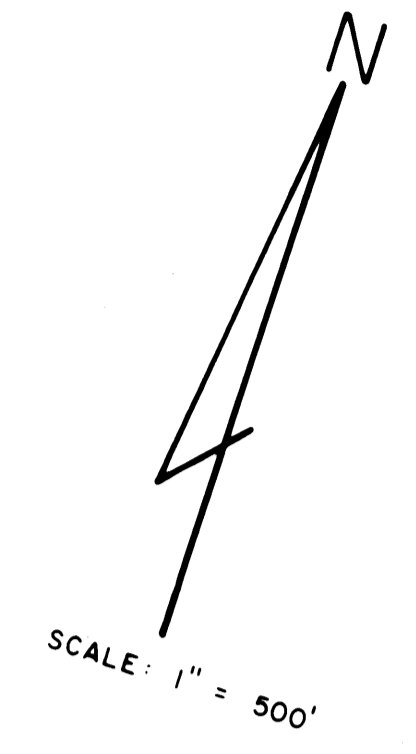

SALERNO ROAD MAINTENANCE MAP

PORTIONS OF ST. LUCIE INLET FARMS
PLAT BOOK 1, PAGE 98
PALM BEACH (NOW MARTIN) COUNTY

FIELD	HULS.
DRAWN BY	
CHECKED BY	B. D.
DATE	
JOB NO	83-084
REVISION	

SEAL

LINDAHL, BROWNING, FERRARI & HELLSTROM, INC.
CONSULTING ENGINEERS, ARCHITECTS & PLANNERS

100 INDIAN LANE ROAD, SUITE 100, BOCA RATON, FLORIDA 33433
1000 BOCA RATON BLVD., SUITE 100, BOCA RATON, FLORIDA 33433
1000 BOCA RATON BLVD., SUITE 100, BOCA RATON, FLORIDA 33433